

Sub: Minutes of 1st Meeting of Building Works Committee, MRSSTU, Bathinda.

The 1st meeting of Building Works Committee of Maharaja Ranjit Singh State Technical University, Bathinda was held under the Chairmanship of Dr. M.P.S. Ishar, Vice Chancellor, MRSSTU, Bathinda on 24th July, 2015 at 11.00A.M. in the office of Vice Chancellor, MRSSTU, Bathinda. The following were present:

1. ✓ Dr. M.P.S. Ishar,
Vice Chancellor,
MRSSTU, Bathinda
2. Dr. J.S. Hundal,
Registrar,
MRSSTU, Bathinda
3. Sh. Subhash Bansal,
For Finance Officer,
MRSSTU, Bathinda
4. Er. Satinderpal Singh Samra
Superintendent Engineer
Nominee of Chief Engineer,
Public Works Deptt. (B & R),
Provincial Division Punjab
5. Er. G.S. Bath,
Head, Deptt. Of Civil Engg.,
GZSCCET, Bathinda
6. Ar. Bhupinder Pal Singh Dhot,
Head, Deptt. Of Architecture,
GZSCCET, Bathinda
7. Er. Jagdeep Singh Sidhu,
For Executive Engineer,
MRSSTU, Bathinda

The following decisions were taken:

ITEM NO 1.1 CONSTRUCTION OF BUILDINGS AT MRSSTU, BATHINDA.

Two options available for the construction of new buildings of Maharaja Ranjit Singh State Technical University, Bathinda were discussed.
1. As per the First option as shown in Drawing-A, the buildings of MRSSTU, Bathinda were Planned on the right hand side of road from Badal Road Gate by demolishing the already constructed two Girls Hostels, Director Residence, Guest House and residences of faculty and staff. By executing this option, an expenditure of about Rs. 50 Crores would be incurred for the relocation of these buildings.



2. As per the Second proposed option as shown in Drawing-B, it was proposed that only D-type and C-type houses be demolished initially for the continuity of planning. The other buildings already constructed be not demolished for the time being. The construction be carried out all along the Badal Road boundary and the vacant land available.

The Committee approved the Second option.

ITEM NO 1.1 .1 CONSTRUCTION OF BUILDINGS IN THE FIRST PHASE.

Decision: Approved.
However, it was decided that the Office of Executive Engineer (Construction and Maintenance Wing) be provided at some other site with proper provision for stores etc.

ITEM NO 1.1 .2 CONSTRUCTION OF BUILDINGS IN THE SECOND PHASE.

Decision: Approved.

ITEM NO 1.1 .3 CONSTRUCTION OF BUILDINGS IN THE THIRD PHASE.

Decision: Approved.

ITEM NO 1.1 .4 PROVISION OF FURNITURE ETC. FOR THE MRSSTU CAMPUS

Decision: Approved.
The details of cost per teacher, per student as discussed in the meeting is incorporated.

ITEM NO 1.2 CONSTRUCTION OF BUILDINGS AT PIT, RAJPURA.

Decision: Approved.

ITEM NO 1.3 REPAIR AND RENOVATION OF BUILDINGS AT PIT, GTBGARH, MOGA.

Decision: Approved.

ITEM NO 1.4 PROVIDING OF EXTERNAL SERVICES AT PIT, NANDGARH

Decision: Approved.

ITEM NO 1.5 FEE FOR PLANNING, ARCHITECTURAL DESIGN ETC.

Decision: It was decided that the following changes be made in the terms and conditions.

1. Provision for fee be enhanced from 2% to 3%.
2. 5% of tendered amount be deposited as Bank Guarantee which will be treated as performance security, and will be released only after the satisfactory completion of work.



3. The above mentioned fee shall not be charged from Architects from Govt./Semi-Govt institutions.

ITEM NO 1.6 BUILDING WORKS AT GIANI ZAIL SINGH CAMPUS COLLEGE OF ENGINEERING AND TECHNOLOGY, BATHINDA

ITEM NO 1.6 .1 CONFIRMATION OF THE PROCEEDINGS OF 11TH MEETING OF BUILDING WORKS COMMITTEE.

Decision: Confirmed.
The construction of new Administrative Block, new Library Building, R & D Centre, Auditorium was deferred since the funds for these buildings were to be provided by the Punjab Technical University, Jalandhar.

ITEM NO 1.6 .2 ACTION TAKEN ON THE DECISION'S TAKEN IN THE 11TH MEETING OF BUILDING WORKS COMMITTEE.

Decision: Approved.
The construction of new Administrative Block, new Library Building, R & D Centre, Auditorium was deferred since the funds for these buildings were to be made by the Punjab Technical University, Jalandhar.

ITEM NO 1.6 .3 RENOVATION OF TOILETS IN CAMPUS.

Decision: Approved.

ITEM NO 1.6 .4 CONSTRUCTION OF MISSING FOOTHPATH LINKS

Decision: Approved as per the Drawing-C attached.

ITEM NO 1.6 .5 CONSTRUCTION OF PARKING AT VARIOUS PLACES

Decision: Approved as per the Drawing-D attached.

ITEM NO 1.6 .6 LAYING OF WATER PROOF TAR FELT OVER WORKSHOP ROOFS

Decision: Approved.

ITEM NO 1.6 .7 CONSTRUCTION OF CC FLOORING IN WORKSHOP

Decision: Approved.

ITEM NO 1.6 .8 CONSTRUCTION OF SILVER JUBILEE GATE AT DABWALI ROAD

Decision: Approved.

ITEM NO 1.6 .9 APPROVAL FOR MINOR WORKS BELOW RS. 05 LACS.

Decision: Approved with the condition that it should be done for a maximum amount of Rs. 15 lacs per year and no single work should be more than Rs. 05 lacs.

ITEM NO 1.6 .10 RATIFICATION OF WORK OF BASKETBALL COURT & FENCING

Decision: Approved.

ITEM NO 1.6 .11 ADDITION OF STORE HALL IN THE EXISTING GYMNASIUM BUILDING

Decision: Deferred.

ITEM NO 1.7 ANY OTHER POINT WITH THE PERMISSION OF CHAIR

ITEM NO. 1.7 (S) RATIFICATION OF THE WORK OF ALTERATION IN STUDENT CENTRE

It was decided that Administrative Offices of the Maharaja Ranjit Singh State Technical University, Bathinda shall be accommodated in the Student Centre. For setting up the offices for the Officers and Staff Members of MRSSTU, Bathinda, some alterations have been made in the Student Centre Building of GZSCCET, Bathinda by providing aluminum partitions. Also, the Examination Branch of the MRSSTU, Bathinda is to be setup in the above building. An expenditure of Rs. 25 lacs is likely to be incurred on the above said works and for providing various other facilities for setting up the Administrative Block of the University.

Decision: Approved.

The meeting ended with a vote of thanks to the Chair.

**Chairman
Buildings Works Committee,
MRSSTU, Bathinda**

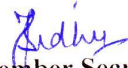

**Member Secretary
Buildings Works Committee,
MRSSTU, Bathinda**

Details of Furniture Cost

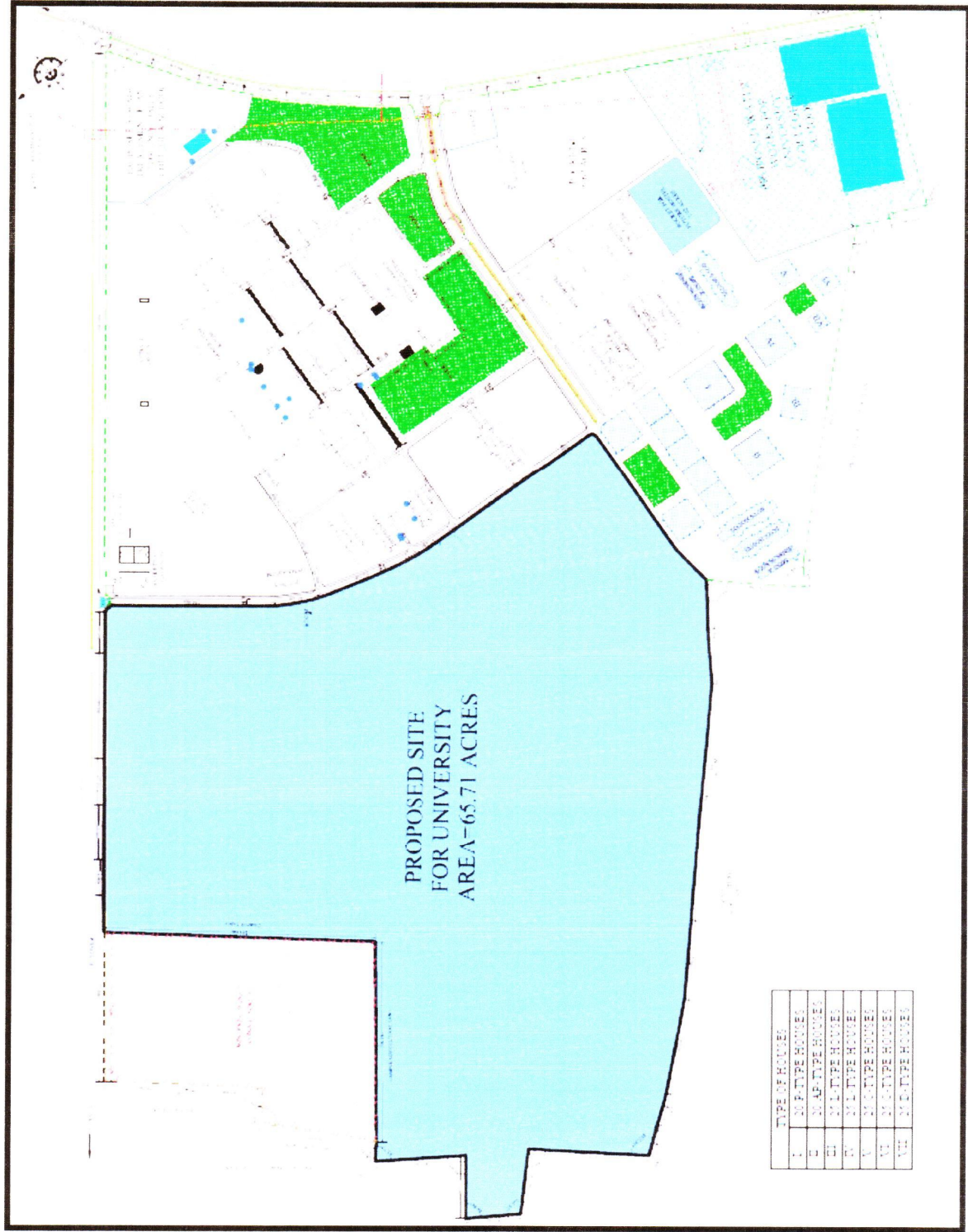
Sr. No	Description	Amount
Cost per Teacher		
1	One Revolving chair	12000/-
2	One table	18000/-
3	Four chairs	16000/-
4	Book Rack	4000/-
5	Computer table	4000/-
6	Almirah	10000/-
7	Curtains	4000/-
8	Computer Chair	7000/-
Total		75000/-
Cost per Student in Academics		
9	Student	5000/-
Cost per Student in Hostels		
10	Bed	4000/-
11	Table	3500/-
12	Chair	2500/-
Total		10000/-
Cost per room in Guest House		
13	Double Bed with side table	21000/-
14	Two Sofas Single	10000/-
15	Centre Table	4000/-
16	LED	30000/-
17	Almirah	10000/-
Total		75000/-

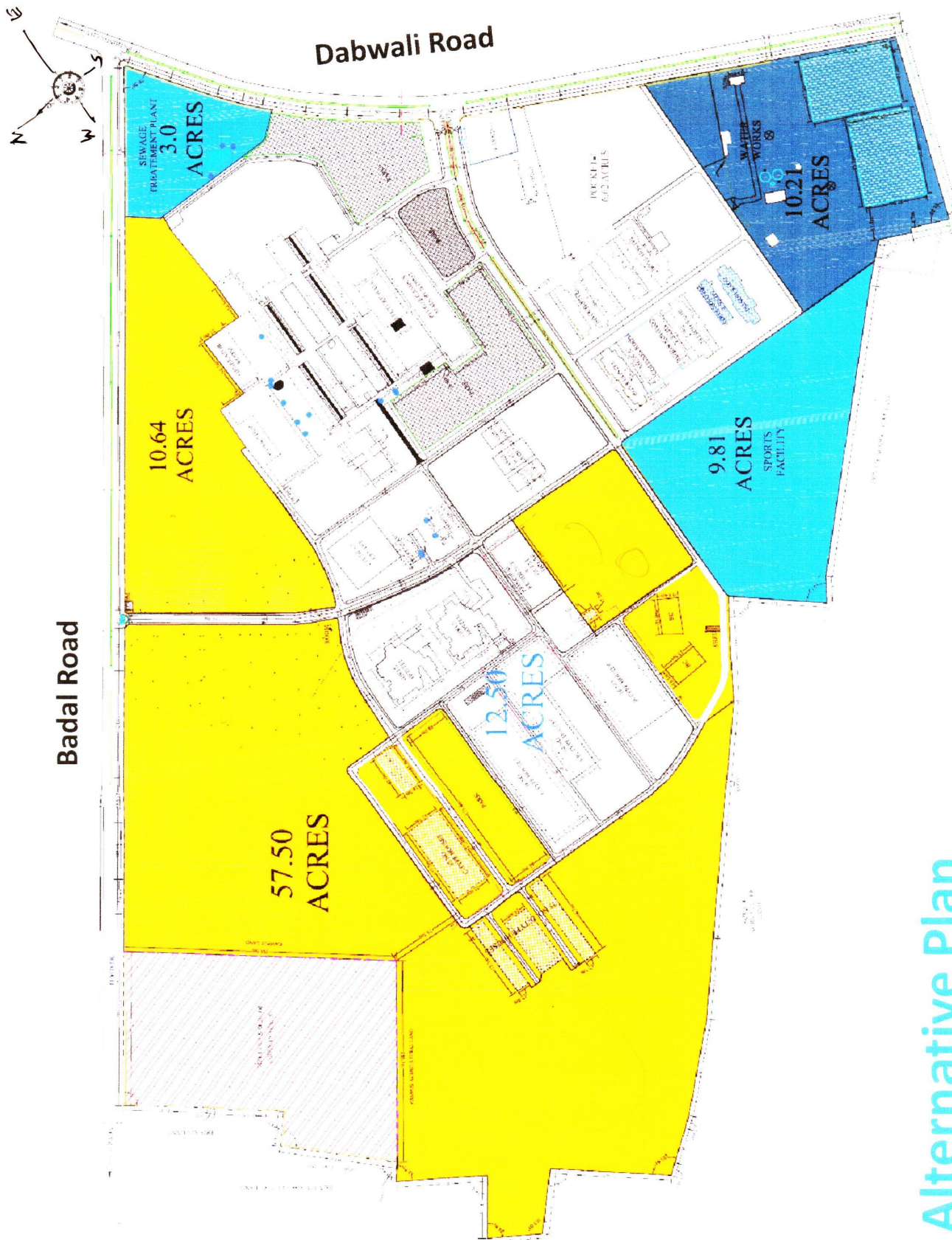

DRAWING-A



Alternative Plan

DRAWING-B

GIANI ZAIL SINGH CAMPUS COLLEGE OF ENGG. AND TECH., BATHINDA

LEGEND:

- A. Main Gate to civil Eng. Deptt
- B. In front of Admin Building
- C. Canteen Hostel no. 3 to Water works
- D. Hostel no 4 parking
- E. Gymnasium to P-Type Parking
- F. From Hockey Ground - D -Type Houses
- G. In Front of P-Type Houses(01-08)
- H. C-1 to AP-15 along Girl's hostel Boundry Wall
- I. Hostel No-1 and 3 crossing to new lecture hall block
- J. Along CC Road Near Post Graduate lecture Hall
- K. In front of Shopping Complex
- L. Dispensary Block Parking
- M. Near Workshop Canteen

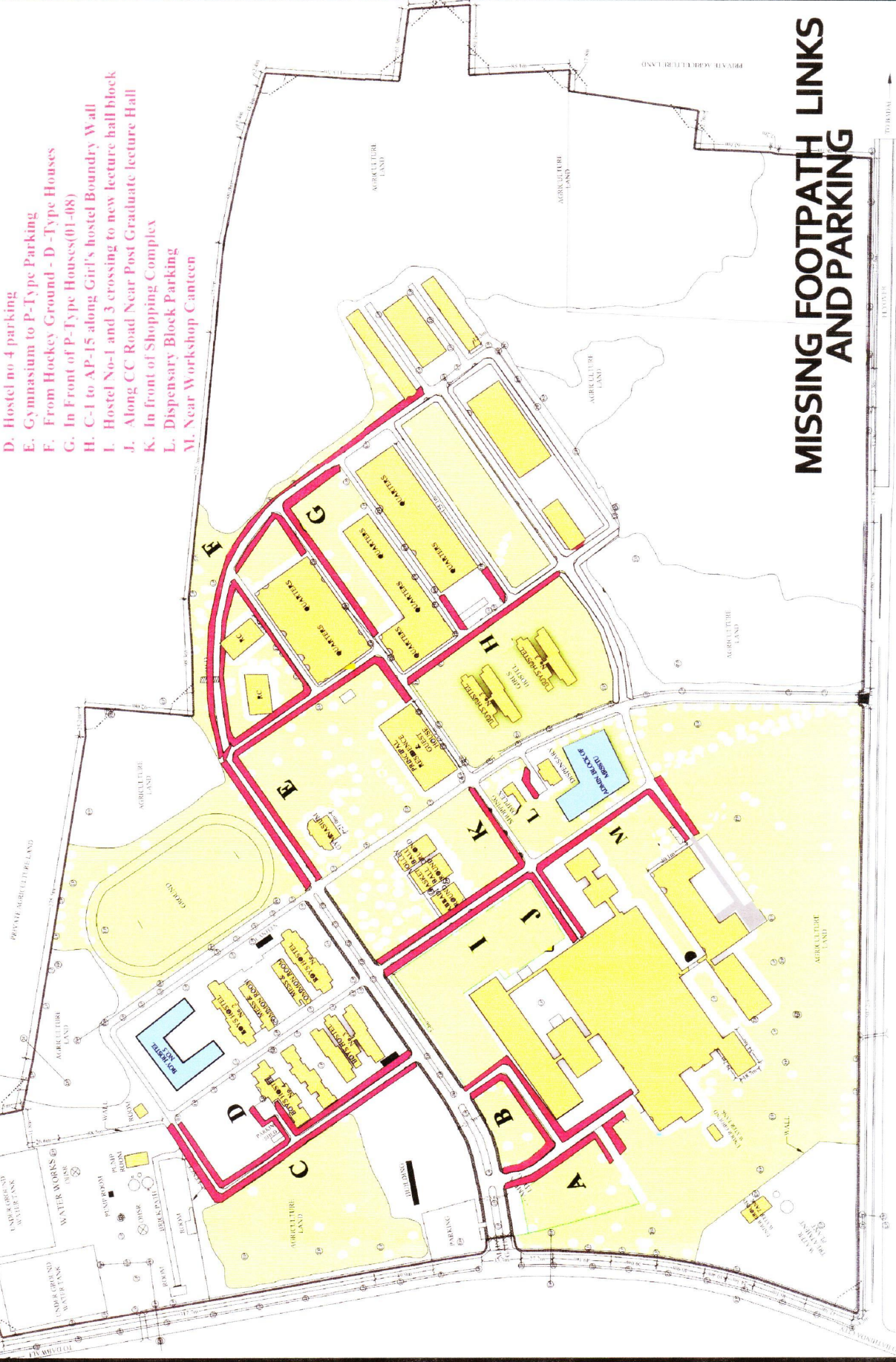

MISSING FOOTPATH LINKS
AND PARKING

DRAWING - C